

# Undermount Rangehood

ORU52XL

ORU70XL

ORU90XL

**omega**

Designed to Enhance  
EST. 1981

@omegaappliances\_au  
omegaappliances.com.au

## Contents

Welcome	03
Safety Information	04
Your Undermount Rangehood	05
Installation Instructions	06
Operating Instructions	08
Cleaning & Maintenance	09
Troubleshooting	10
Purchase Details	12
Warranty Information	14

# Welcome

**Residentia Group**

—

**Head Office**

165 Barkly Avenue  
Burnley Victoria  
Australia 3121

—

**ACN**

600 546 656

—

**Online**

residentia.group  
omegaappliances.com.au  
@omegaappliances\_au

—

**Postage**

PO BOX 5177, Burnley  
VIC Australia 3121

—

**Telephone**

1300 11 4357

—

**Email**

support@residentia.group

Congratulations on purchasing your Undermount Rangehood. Omega appliances are proudly owned and distributed within Australia by Residentia Group Pty Ltd.

Please refer to the warranty chapter at the rear of this manual for information regarding your product's parts and labour warranty, or visit us online at:

→ [residentiagroup.com.au](http://residentiagroup.com.au)

Here at Residentia Group, we are customer obsessed and our Support Team are there to ensure you get the most out of your appliance. Should you want to learn more about your unit, and importantly, taking care of the appliance, our Support Team are here to help. You can use our online Support Centre at any time by visiting:

→ [support.residentiagroup.com.au](http://support.residentiagroup.com.au)

Or you can contact us by dialling: 1300 11 HELP (4357)

It is important that you read through the following user manual thoroughly, in order to familiarise yourself with the installation and operation requirements of your appliance, and to ensure optimum performance.

Again, thank you for choosing an Omega appliance. We look forward to being of service to you.

Kind Regards,  
The Residentia Team

**Customer Care**

—

At Residentia Group, we strongly encourage the use of authentic spare parts to guarantee the best results. When contacting our spare parts team through 1300 11 HELP, or by emailing [parts@residentiagroup.com.au](mailto:parts@residentiagroup.com.au), please ensure that you have the model and serial numbers on hand, which are found on your appliances' rating plate.

# Safety Information

## Important Safety Instructions

- In certain circumstances electrical appliances may be a safety hazard.
- This appliance is not intended for use by persons (including children) with reduced physical, sensory or mental capabilities, or lack of experience or knowledge, unless they have been given supervision or instruction concerning the use of the appliance by a person responsible for their safety. Young children should be supervised to ensure that they do not play with the appliance.
- Do not check the status of the filters whilst the cooker hood is operating.
- Do not touch the light bulbs after use.
- Do not disconnect the appliance with wet hands.
- Do not disconnect the power supply by pulling on the cable.
- Do not flambé underneath the rangehood.
- Avoid free flame, as it may cause damage to the filters and can be a fire hazard.
- Unplug the appliance before carrying out maintenance, cleaning or replacing lamps.
- If the power cord is damaged, it must be replaced by the manufacturer, an authorised service centre or similarly qualified persons to avoid a hazard.
- For indoor use only.
- It is recommended to operate the rangehood prior to cooking.
- It is recommended to leave the rangehood in operation for 15 minutes after cooking is terminated in order to completely eliminate cooking vapours and odours.
- Turn off the rangehood when not in use.
- Do not use the rangehood if it is damaged, especially the supply cord and the case.
- Do not immerse the rangehood in liquid.
- The exhaust air must not be discharged into a flue which is used for exhausting fumes from an appliance burning gas or other fuels (not applicable to appliances that only discharge the air back into the room).
- Regulations concerning the discharge of air have to be fulfilled.
- There shall be adequate ventilation of the room when the rangehood is used at the same time as appliances burning gas of other fuels (not applicable to appliances that only discharge the air back into the room).
- Clean the surface of the cooker hood regularly using a cloth moistened with denatured alcohol or a non-abrasive liquid detergent.
- There is a fire risk if cleaning is not carried out in accordance with the instructions.
- The 600mm units are intended for use above cooktops that are 600mm wide and the 900mm units are intended for use above cooktops that are 900mm wide.
- The rangehood must be mounted at a minimum distance of 65cm above the cooking surface. If the installation instructions for your cooktop specify a greater distance than the minimum, then that shall be the minimum height for installation.
- **CAUTION:** Accessible parts may become hot when used with cooking appliances.
- **WARNING:** Failure to install the screws or fixing device in accordance with these instructions may result in electrical hazards.

# Your Undermount Rangehood

## Product Specifications

Model	ORU52XL	ORU70XL	ORU90XL
Extraction	1000m <sup>3</sup> /hr	1000m <sup>3</sup> /hr	1000m <sup>3</sup> /hr
Dimensions (W × D × H mm)	520 × 296 × 254	700 × 296 × 254	900 × 296 × 254
Cut-out (W × D mm)	490 × 265	665 × 265	865 × 265
Weight	6.5 kg	8.7 kg	10.0 kg
Speed Settings	3	3	3
Lighting	2 × 3W GU10 LED	2 × 3W GU10 LED	2 × 3W GU10 LED
Aluminium Filters	1 × 5-Layer Mesh	2 × 5-Layer Mesh	3 × 5-Layer Mesh
Motor	265W	265W	265W
Voltage	220–240V ~50Hz	220–240V ~50Hz	220–240V ~50Hz
Max Noise Level	68 dB(A)	68 dB(A)	68 dB(A)

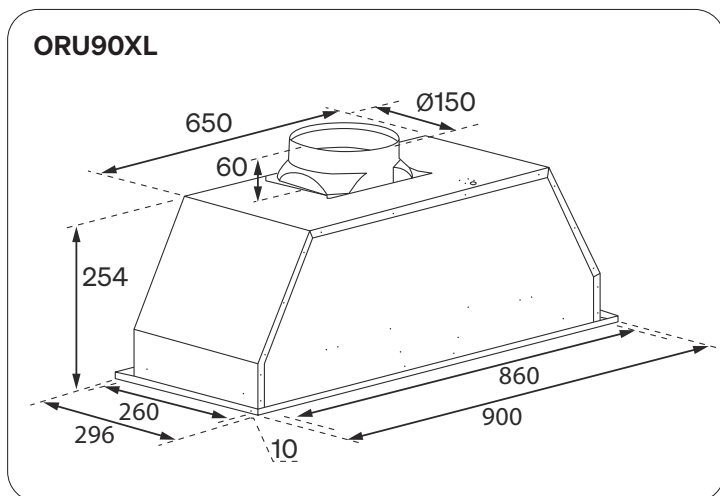
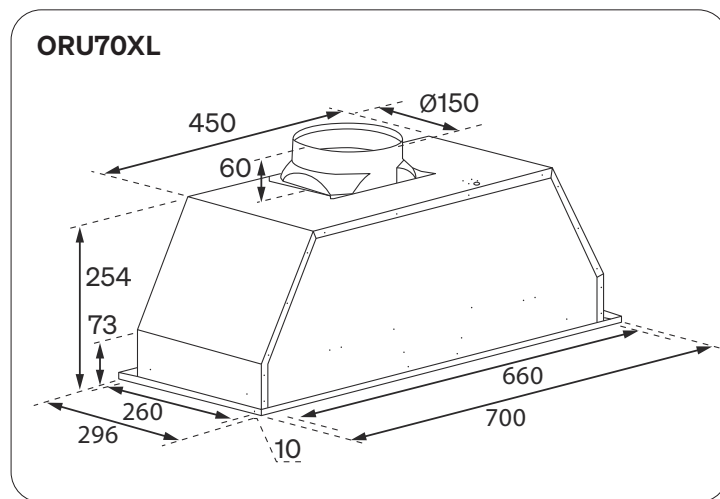
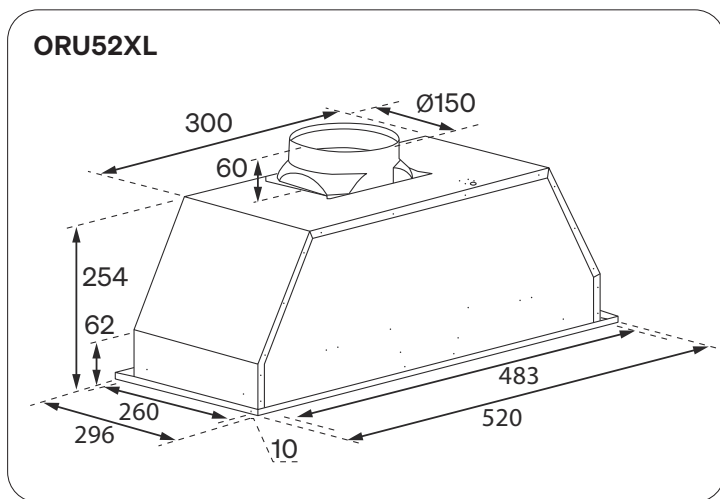

# Installation Instructions

## Prior to Installing the Rangehood

Before beginning the installation of your rangehood, consider your ducting method.

This rangehood has been supplied with expandable plastic ducting, however for maximum performance we recommend installing with rigid or semi rigid ducting. Use cable ties or suitable duct tape to secure the flexible pipe or ducting to the rangehood duct outlet.

## Recirculating Installation

We recommend ducting your rangehood wherever possible, for the maximum performance, however this rangehood can be operated in recirculating mode. You will need to purchase the relevant Carbon Filter accessory which is available for purchase from our After Sales Service Team.

## Ducted Installation

**WARNING:** All ducting must be fire retardant.

Depending on your situation, there are multiple options for ducting your rangehood, as follows:

- Straight up through your tiled or metal roof, using a roof cowl (not supplied with the rangehood).
- Into your ceiling cavity (where compliant with local and national building regulations/codes. Seek approval from the relevant authority or building inspector where necessary).
- Into your ceiling cavity and then vented to the atmosphere through your eaves, using no more than 2 × 90 degree bends within the ducting run.
- Through your wall.

**IMPORTANT:** Ducting can have a major effect on your rangehoods performance. The following tips outline how to correctly duct your rangehood.

- Always use the correct size ducting. This rangehood is designed for use with 150mm ducting to achieve optimum airflow performance and minimised noise.
- For maximum performance use semi rigid or rigid ducting
- Always use non-flammable ducting
- Always duct to the outside atmosphere, unless your local building codes and regulations permit otherwise
- Where using flexible ducting, always install the ducting pulled taut to minimize pressure loss, and cut any excess ducting off.
- Where possible, avoid using 90 degree bends and in their place use multiple 45 degree bends.
- Keep your total length of ducting to the shortest length possible.
- Ensure there are no kinks in your ducting.
- Use cylindrical ducting whenever possible

## Installation Instructions (Continued)

### Installation Safety Instructions

- **WARNING:** Please ensure that all power is switched off before installing the rangehood.
- **IMPORTANT:** Before installing your rangehood, please record the details of your rangehood's rating label (located within the rangehood, behind the aluminium grease filters) into the form on page 12. This will be helpful should you need to contact our service team in the future.
- Installation must be in accordance to the local electrical authority and codes.
- The switched power outlet for the range hood should be positioned to enable the user to turn the power off, to enable cleaning and any maintenance required.
- The switched power outlet should be installed within 600mm from the rear of the unit.
- Ensure that when installing the rangehood, that it is protected from any possible damage from tools etc.
- Ducting for this unit must be installed in accordance to the local authority.
- Ensure that the fixings used for installing this rangehood are suitable.
- Check the area where the rangehood is to be fitted, to ensure that it is structurally sound.
- Before using the appliance, remove the plastic coatings protecting the stainless-steel finish.
- These models are intended to be installed into the kitchen cabinetry.
- Take care that the cabinetry and supporting wall can carry the weight of the rangehood.
- Always double-check dimensions in this manual against the appliance before commencing.
- The rangehood should be placed at a minimum distance of 650mm from the cooking surface of the cooker below. Any more than 750mm could compromise the performance of the appliance.
- Drill a cut-out hole into the cupboard according to the table on page 5 based on your model.
- Make sure the distance between the edge of the hole and the edge of the cupboard edge is at least 35mm.
- Remove the filter and remove the four screws holding the lower panel in place.
- Lift the appliance into the cut-out hole and check that it fits correctly (no gaps, does not interfere with anything above it etc.).
- Mark the hole positions with a pencil, remove the appliance and pre-drill the holes using a small drill bit.
- Place the appliance back into position, line up the holes and fix into place using the 8 screws provided.
- Replace the cover & fix into position with the 4 screws and fit the filter.
- Fit the one-way filter to the top of the unit.
- The exhaust air vents through the one-way valve at the top.
- If the exhaust is to be vented away, cut a hole (~Ø160mm) in the top of the cupboard, and connect Ø150mm ducting to the one-way valve & pass it through the hole to wherever it is going.
- If the exhaust air is to be recirculated back into the room, either cut vents into the cupboard (with a minimum area of 800cm<sup>2</sup>), or leave the cupboard door open when in use.
- Once assembled in place, the appliance can be connected to the power supply.

# Operating Instructions

## Using Your Appliance

**NOTE:** Before the unit can be operated, it must either be ducted or, if the model is installed as a re-circulating range hood, it must be fitted with charcoal filters (one set supplied with the appliance).

With the appliance fully installed and the power connected, the appliance can be used.

Your Undermount Rangehood features push button controls with three speed levels of extraction.

### Speed Settings

- Push the '1' button, and the rangehood will operate at a low speed.  
Ideal for light frying, simmering water, etc.
- Push the '2' button, and the rangehood will operate at a medium speed.  
Ideal for frying, wok cooking, heavy boiling water, etc.
- Push the '3' button, and the rangehood will operate at a high speed.  
Ideal for grilling, intensive frying, wok cooking, stir frying, etc.
- Push the '0' button to switch the rangehood fan off.

### Lights

- Push the 'Light' button and the LED lights will turn on.  
To turn the lights off, simply push the 'Light' button again.

## CONTROLS

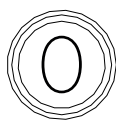



## Cleaning & Maintenance

### Safety Precautions

- Before cleaning your rangehood or performing any maintenance, please ensure that the rangehood is turned off at the power point.
- Do not use abrasive cleaners to clean the rangehood. We recommend the use of warm soapy water and a cloth.
- Ensure that the rangehood is cleaned regularly, as a build-up of grease and fat may occur otherwise.
- The filters on the rangehood must be cleaned regularly to maintain efficiency, and prevent grease build up.
- The filter mesh is made of a high-density stainless steel. It is recommended that this is undertaken every 4–6 weeks, depending on frequency of use. The filters can be cleaned with warm soapy water or a cloth.
- Cleaning of the rangehood must be performed as described above; otherwise there is a possibility of a fire hazard due to grease and fat build up.

### Replacing the LED lights

**WARNING:** Before attempting to replace the lights, ensure that the appliance is switched off and unplugged from the wall.

- Remove the aluminium filter.
- Press the lamp face and turn anti-clockwise to remove.
- Replace with the same type of bulb (GU10 Base, 3W MAX).
  - Max Wattage:  $2 \times 3\text{W}$
  - Voltage Range: 220 – 240V AC
  - ILCOS D Code: DR-3/65/1B-H-GU10-46/50
- Replace the aluminium filter.

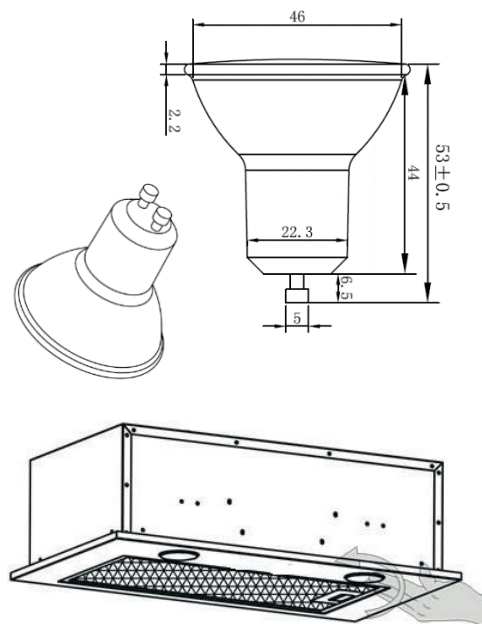

**NOTE:** The diagram images in this user manual are for explanatory purposes only. Your appliance may appear differently.

# Troubleshooting

## Operation in case of emergency

In the event of an emergency you should:

- Switch off all rangehood controls.
- Switch the rangehood off at the power outlet and immediately unplug.
- Call the Customer Service team on 1300 11 4357 or email [support@residentiagroup.com.au](mailto:support@residentiagroup.com.au)

Some minor faults can be fixed by referring to the instructions given in this Troubleshooting section.

There is also a self-help section online at <https://support.residentiagroup.com.au>

**IMPORTANT:** If your appliance appears to be operating incorrectly, then you should disconnect it from your electrical supply and then contact After Sales Support.

**WARNING:** Do not attempt to repair the rangehood yourself.

Please note that if an technician is asked to attend whilst the product is under warranty and finds that the problem is not the result of an appliance fault, then you may be liable for the cost of the call out charge.

The appliance must be accessible for the engineer to perform any necessary repair.

If your appliance is installed in such a way that an engineer is concerned that damage will be caused to the appliance or your kitchen, then they will not complete a repair. This includes situations where the rangehood has been tiled in or sealed in with a sealant.

Please refer to the conditions of that appear on the warranty card at the rear of this user manual.

## Troubleshooting (Continued)

<b>Problem</b>	<b>Possible Cause</b>	<b>Solution</b>
The lights turn on but the motor does not operate.	The fan switch may be turned off.	Select a fan speed option.
	The fan switch may have failed.	Contact our Customer Service team.
	The motor may have failed.	Contact our Customer Service team.
The lights do not turn on and the motor does not operate.	The house fuses may have blown.	Replace fuse or reset the circuit breaker (repaired by professional personnel).
	The power cord may be loose or disconnected from the outlet.	Refit cord to power outlet or switch the power outlet on.
There is an oil leakage present.	The one-way valve and the air ventilation entrance may not be tightly sealed	Take down the one-way valve and seal with sealant.
	Leakage from the connection of U-shaped section and cover.	Take the U-shaped section down and seal
The lights do not turn on.	The light may have blown or is faulty.	Follow the instructions on page 9 on how to replace the LED lights or contact our Customer Service team should you need assistance.
Insufficient extraction suction.	The distance between the rangehood and the cooktop may be too far.	Refit the rangehood to the correct installation distance.
	The ducting may have too many bends, is loose, kinked or too long.	Check that your rangehood has been ducted correctly and in accordance with the installation instructions.
The rangehood inclines.	The fixing screws are not tight enough.	Tighten the hanging screws until the rangehood is level.

## Purchase Details

For future reference, please record the following information which can be found on the rating plate and the date of purchase which can be found on your sales invoice.

### STORE DETAILS

---

Store Name		
Address		
Telephone		Purchase Date

### PRODUCT DETAILS

---

Model No.		
Serial No.*		

Attach Your Receipt Here





# Warranty Information

## WARRANTY TERMS AND CONDITIONS RANGEHOODS

This document sets out the terms and conditions of the product warranties for Residentia Group Appliances. It is an important document. Please keep it with your proof of purchase documents in a safe place for future reference should you require service for your Appliance.

### 1. IN THIS WARRANTY

- (a) 'acceptable quality' as referred to in clause 10 of this warranty has the same meaning referred to in the ACL;
  - (b) 'ACL' means Trade Practices Amendment (Australian Consumer Law) Act (No.2) 2010;
  - (c) 'Appliance' means any Residentia Group product purchased by you accompanied by this document;
  - (d) 'ASR' means Residentia Group authorised service representative;
  - (e) 'Residentia Group' means Residentia Group Pty Ltd of 165 Barkly Ave, Burnley VIC 3121, ACN 600 546 656 in respect of Appliances purchased in Australia;
  - (f) 'major failure' as referred to in clause 10 of this warranty has the same meaning referred to in the ACL and includes a situation when an Appliance cannot be repaired or it is uneconomic for Residentia Group, at its discretion, to repair an Appliance during the Warranty Period;
  - (g) 'Warranty Period' means:
    - (i) where the Appliance is used for personal, domestic or household use (i.e. normal single family use) as set out in the instruction manual, the Appliance is warranted against manufacturing defects for 24 months, following the date of original purchase of the Appliance;
  - (h) 'you' means the purchaser of the Appliance not having purchased the Appliance for re-sale, and 'your' has a corresponding meaning.
2. This warranty only applies to Appliances purchased and used in Australia and is in addition to (and does not exclude, restrict, or modify in any way) any non-excludable statutory warranties in Australia.
  3. During the Warranty Period Residentia Group or its ASR will, at no extra charge if your Appliance is readily accessible for service, without special equipment and subject to these terms and conditions, repair or replace any parts which it considers to be defective. Residentia Group or its ASR may use remanufactured parts to repair your Appliance. You agree that any replaced Appliances or parts become the property of Residentia Group. This warranty does not apply to light globes, batteries, seals, filters or similar perishable parts.
  4. Parts and Appliances not supplied by Residentia Group are not covered by this warranty.

## Warranty Information (Continued)

5. You will bear the cost of transportation, travel and delivery of the Appliance to and from Residentia Group or its ASR. If you reside outside of the service area, you will bear the cost of:
  - (a) travel of an authorised representative;
  - (b) transportation and delivery of the Appliance to and from Residentia Group or its ASR, in all instances, unless the Appliance is transported by Residentia Group or its ASR, the Appliance is transported at the owner's cost and risk while in transit to and from Residentia Group or its ASR.
6. Proof of purchase is required before you can make a claim under this warranty.
7. You may not make a claim under this warranty unless the defect claimed is due to faulty or defective parts or workmanship. Residentia Group is not liable in the following situations (which are not exhaustive):
  - (a) the Appliance is damaged by:
    - (i) accident
    - (ii) misuse or abuse, including failure to properly maintain or service
    - (iii) normal wear and tear
    - (iv) power surges, electrical storm damage or incorrect power supply
    - (v) incomplete or improper installation
    - (vi) incorrect, improper or inappropriate operation
    - (vii) insect or vermin infestation
    - (viii) failure to comply with any additional instructions supplied with the Appliance;
  - (b) the Appliance is modified without authority from Residentia Group in writing;
  - (c) the Appliance's serial number or warranty seal has been removed or defaced;
  - (d) the Appliance was serviced or repaired by anyone other than Residentia Group, an authorised repairer or ASR.
8. This warranty, the contract to which it relates and the relationship between you and Residentia Group are governed by the law applicable where the Appliance was purchased.
9. To the extent permitted by law, Residentia Group excludes all warranties and liabilities (other than as contained in this document) including liability for any loss or damage whether direct or indirect arising from your purchase, use or non use of the Appliance.
10. For Appliances and services provided by Residentia Group in Australia, the Appliances come with a guarantee by Residentia Group that cannot be excluded under the Australian Consumer Law. You are entitled to a replacement or refund for a major failure and for compensation for any other reasonably foreseeable loss or damage. You are also entitled to have the Appliance repaired or replaced if the Appliance fails to be of acceptable quality and the failure does not amount to a major failure. The benefits to you given by this warranty are in addition to your other rights and remedies under a law in relation to the Appliances or services to which the warranty relates.
11. At all times during the Warranty Period, Residentia Group shall, at its discretion, determine whether repair, replacement or refund will apply if an Appliance has a valid warranty claim applicable to it.
12. Missing parts are not covered by warranty. Residentia Group reserves the right to assess each request for missing parts in a case by case basis. Any parts that are not reported missing in the first week after purchase will not provide free of charge.
13. To enquire about claiming under this warranty, please follow these steps:
  - (a) carefully check the operating instructions, user manual and the terms of this warranty;
  - (b) have the model and serial number of the Appliance available;
  - (c) have the proof of purchase (e.g. an invoice) available;
  - (d) telephone the numbers shown below.
14. You accept that if you make a warranty claim, Residentia Group and its ASR may exchange information in relation to you, in order to enable Residentia Group to meet its obligations under this warranty.

### IMPORTANT

Before calling for service, please ensure that the steps in point 13 have been followed.

### CONTACT SERVICE

→ Please call 1300 11 HELP (4357)

The Australian Consumer Law requires the inclusion of the following statement with this warranty:

Our goods come with guarantees that cannot be excluded under the Australian Consumer Law. You are entitled to a replacement or refund for a major failure and for compensation for any other reasonably foreseeable loss or damage. You are also entitled to have the goods repaired or replaced if the goods fail to be of acceptable quality and the failure does not amount to a major failure.



EST. 1981

# Designed to Enhance

# omega

Omega is proudly owned in Australia  
by Residentia Group Pty. Ltd.

@residentia.group  
[www.residentia.group](http://www.residentia.group)